

FLAT SEAL

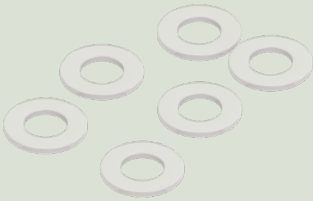

Laboratorier og analyse, industriel proces

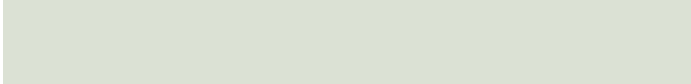

Produkter

Model	Varenummer
151862	FLAT SEAL PA 6.6 FOR P. GAUGE G1/4
151606	PAKNINGER-UDGLØDET CUFOR G1/4-TILSL(X10)
151607	PAKNINGER-UDGLØDETCUF/M10*100-TILSL
17204	FLAT SEAL PTCFE (KEL-F®) 11X5X2
82075	SEAL 18X12X1,5MM COPPER
124737	FLAT SEAL FOR GAUGE G1/4 5,2X 9,6X 3 ALU
167800	PAKNINGSSÆT PA 6.6 TIL MANO 10X1
17203	FLAT SEAL PTCFE (Kel-F®) 18x11,8x2
17133	SEAL CONIQUE PTFE (TEFLON®) 11,5X7,2X3
17206	KIT SEALS ALU P.GAUGE G1/4
17207	FLAT SEAL PTCFE (Kel-F®) 18x7x2
29053	FLAT SEAL PA 6-6 20x12x2
29186	FLAT SEAL PA 6-6 14x9x2
29187	PACKNING 18X11,8X2 MM NYLON
29226	FLAT SEAL PTCFE (Kel-F®) 16x9,2x2
175548	KIT 2 SÆLER 18x12x1,5 MM UDGLØDET KOBBER
17141	FLAT SEAL PTCFE (Kel-F®) 14,5x10x2